

Item No. 7f_Supp

Date of Meeting May 10, 2011

Port of Seattle Art Project Briefing

•Aviation

- Airport North Entry Art
- Garage 4th Floor Walkway
- Rental Car Facility Helices
- Rental Car Facility Employee Parking Screen
- Art Pool

•Seaport

- Smith Cove Cruise Terminal

North Entry - Before



Side Elevation Artist Rendering

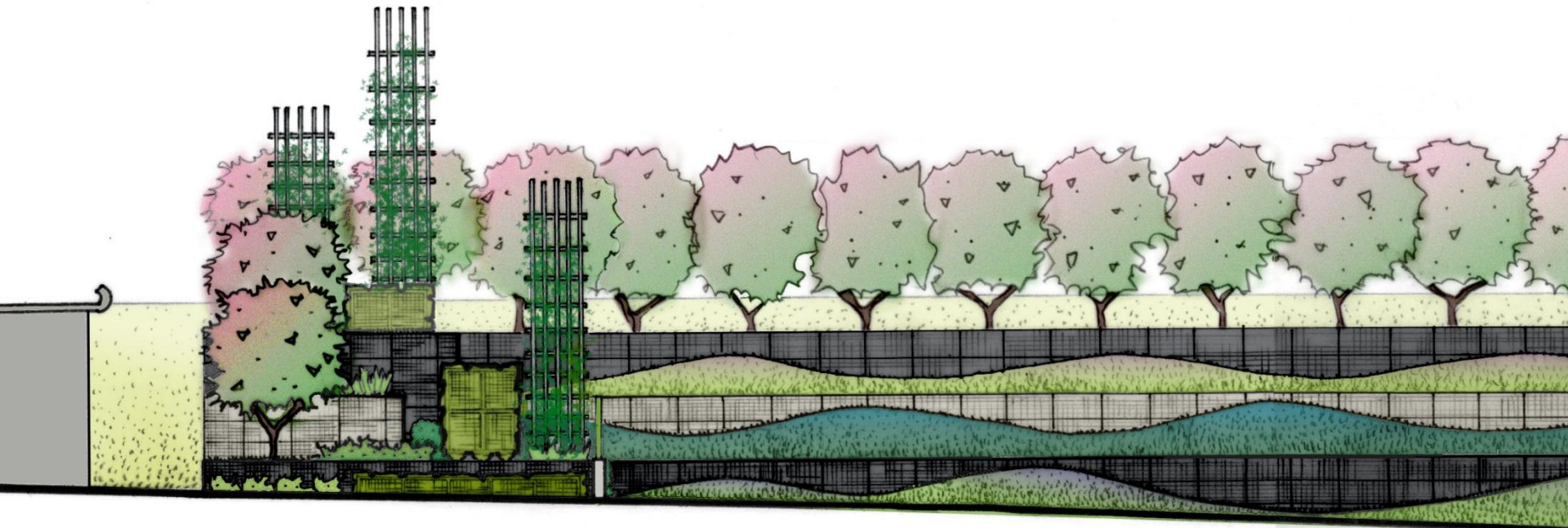

New Plantings



LIGHTING

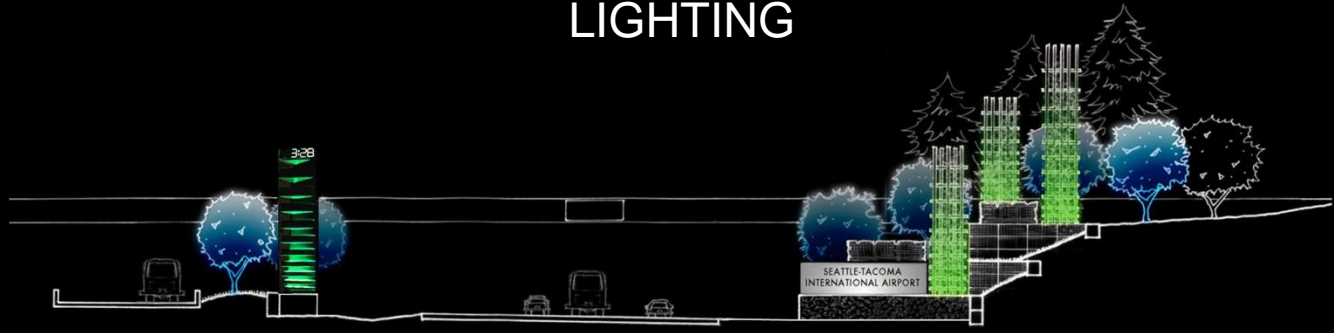

ELEVATION



PLAN

SEATTLE-TACOMA
INTERNATIONAL AIRPORT





9:07 PM
39°F

3:28

3:28

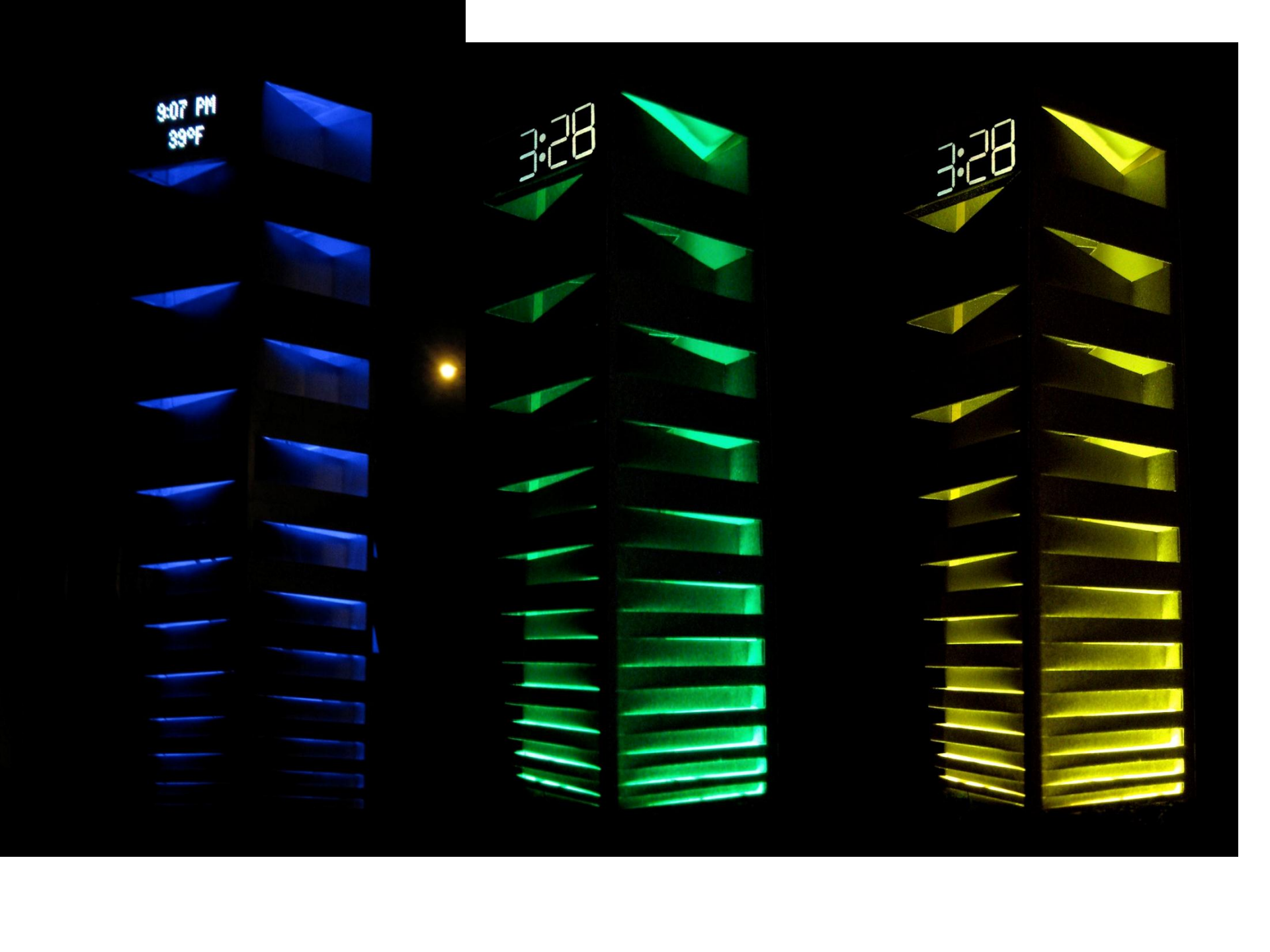

Exit Gabions

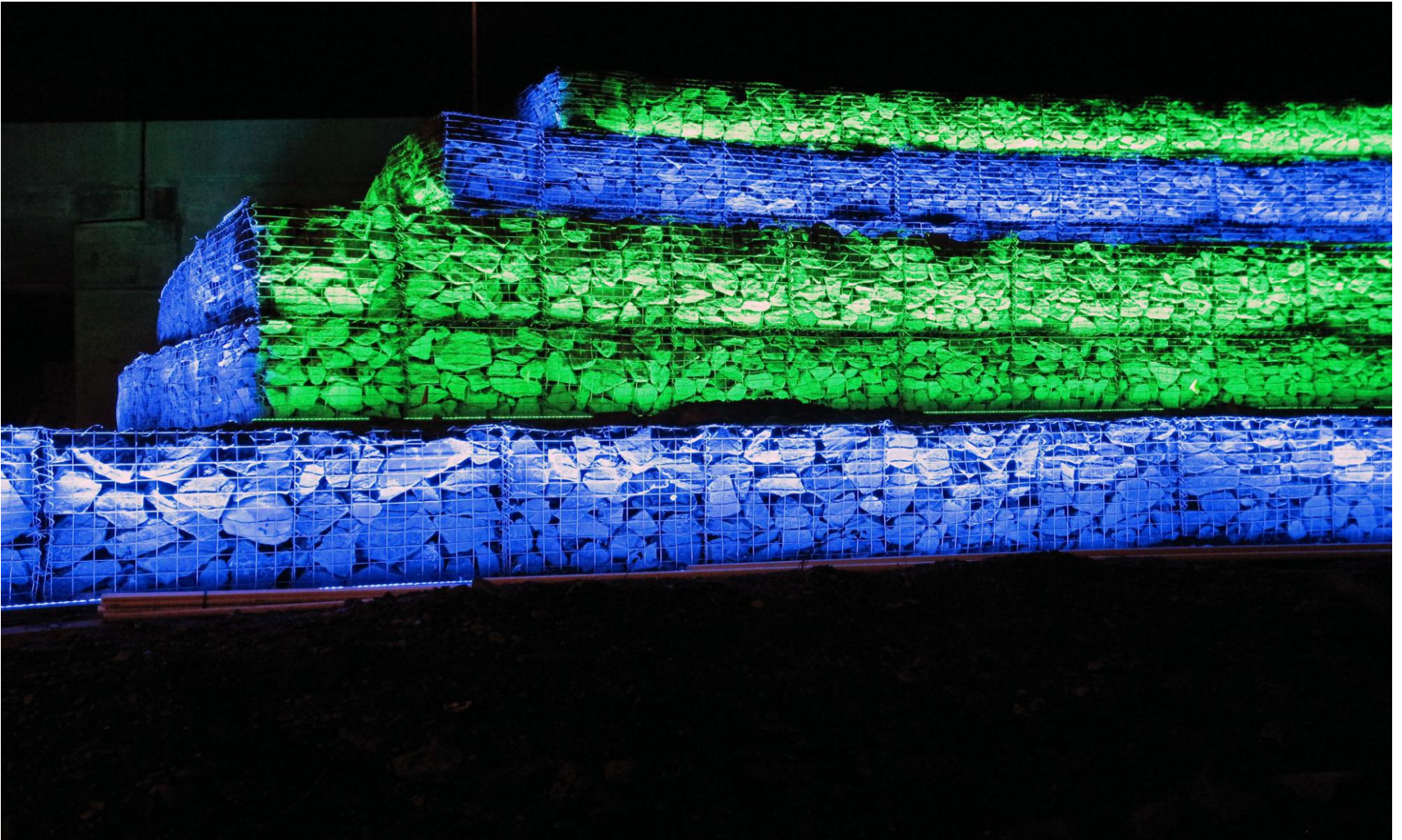

4th Floor Walkway

Photo examples of LED lighting and effects that could be achieved in the 4th Floor Walkway.

“Light Channels” Bill Fitzgibbons

San Antonio Arts Commission



Unknown Location and Artist



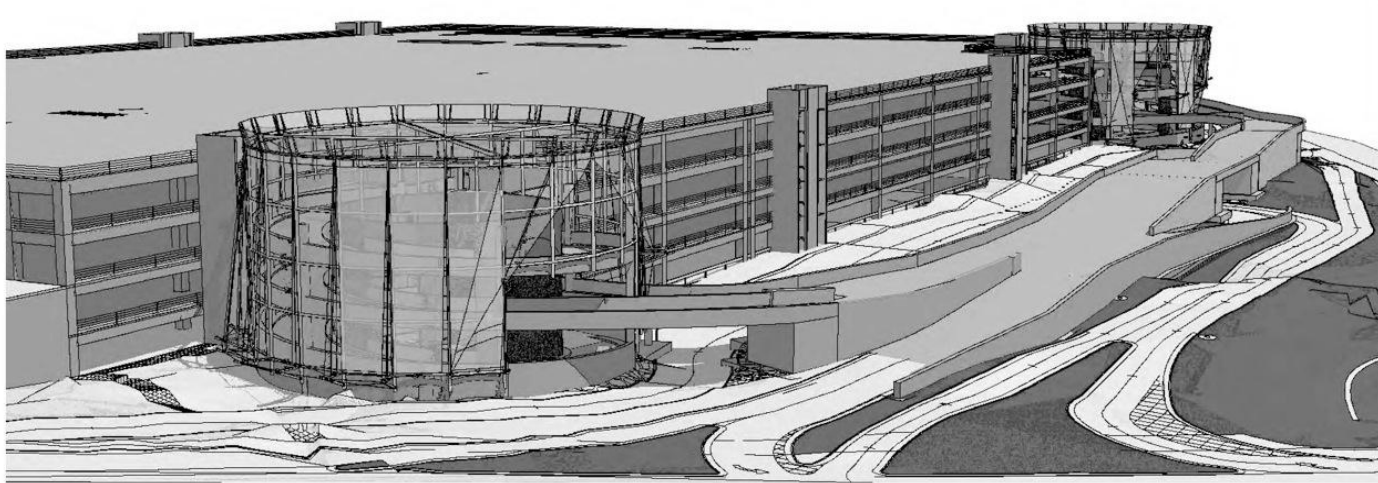

RENTAL CAR FACILITY
SEATAC INTERNATIONAL AIRPORT
ARTWORK: HELIX SCRIM
90% CONSTRUCTION DOCUMENT

Buster Simpson

www.bustersimpson.net

901 Yakima Avenue S., Seattle, WA 98144 206.328.6212 tel & fax buster@bustersimpson.net

Architect Designed Screening

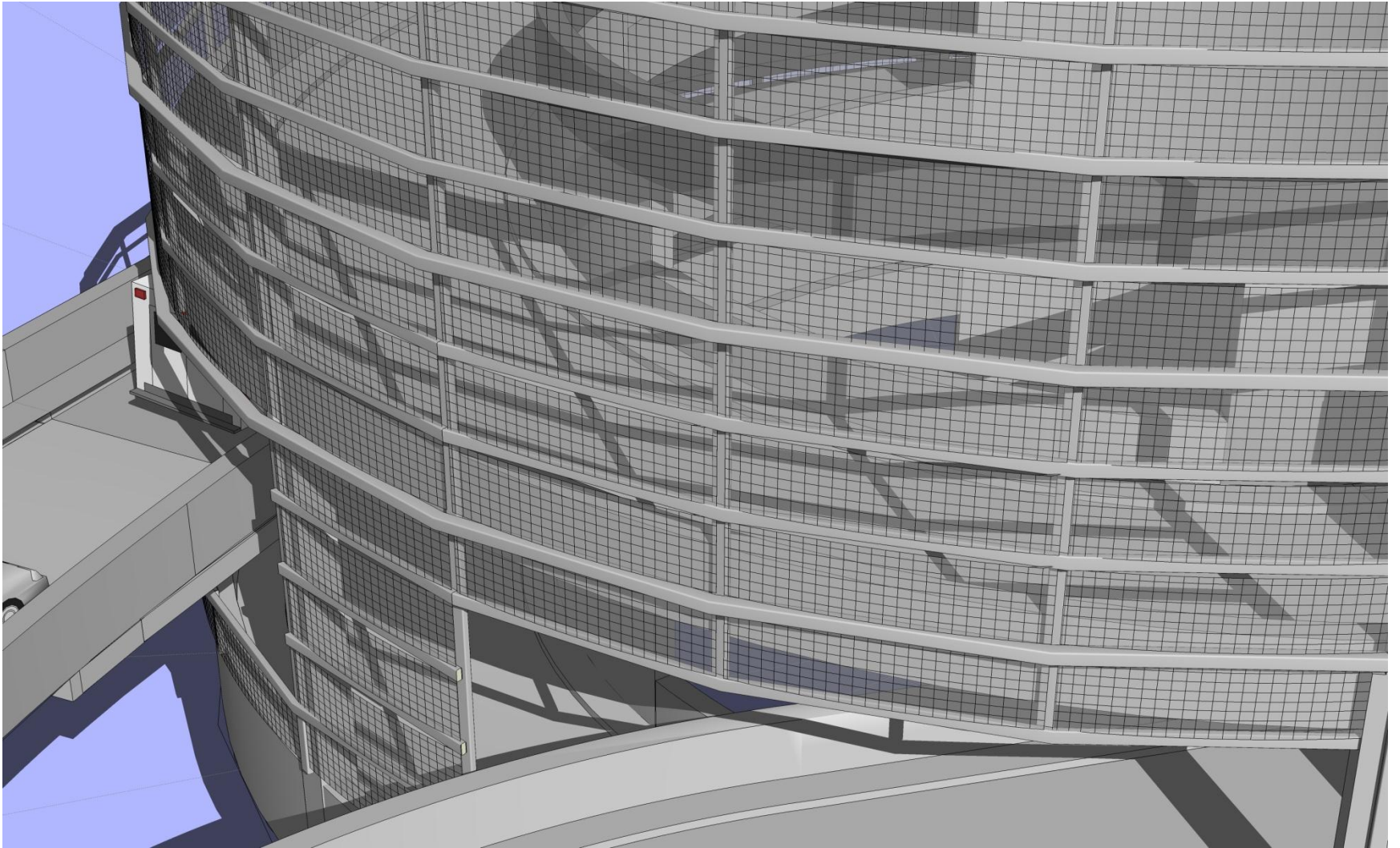

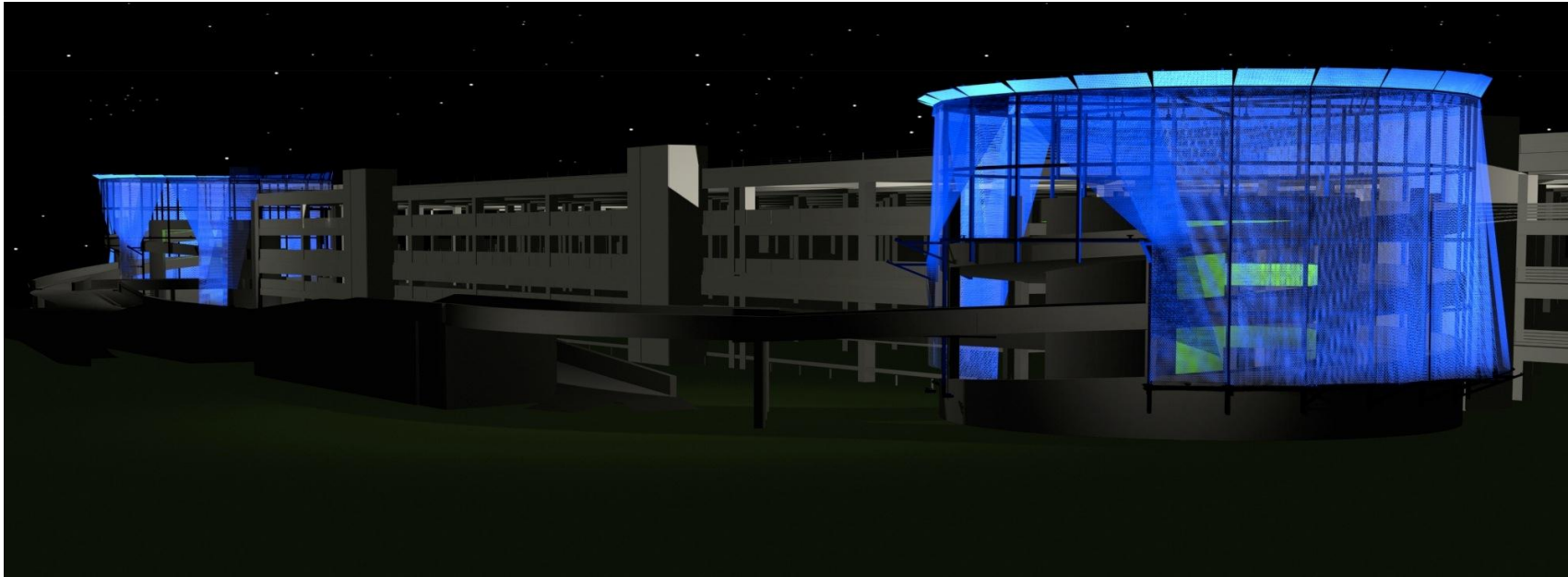

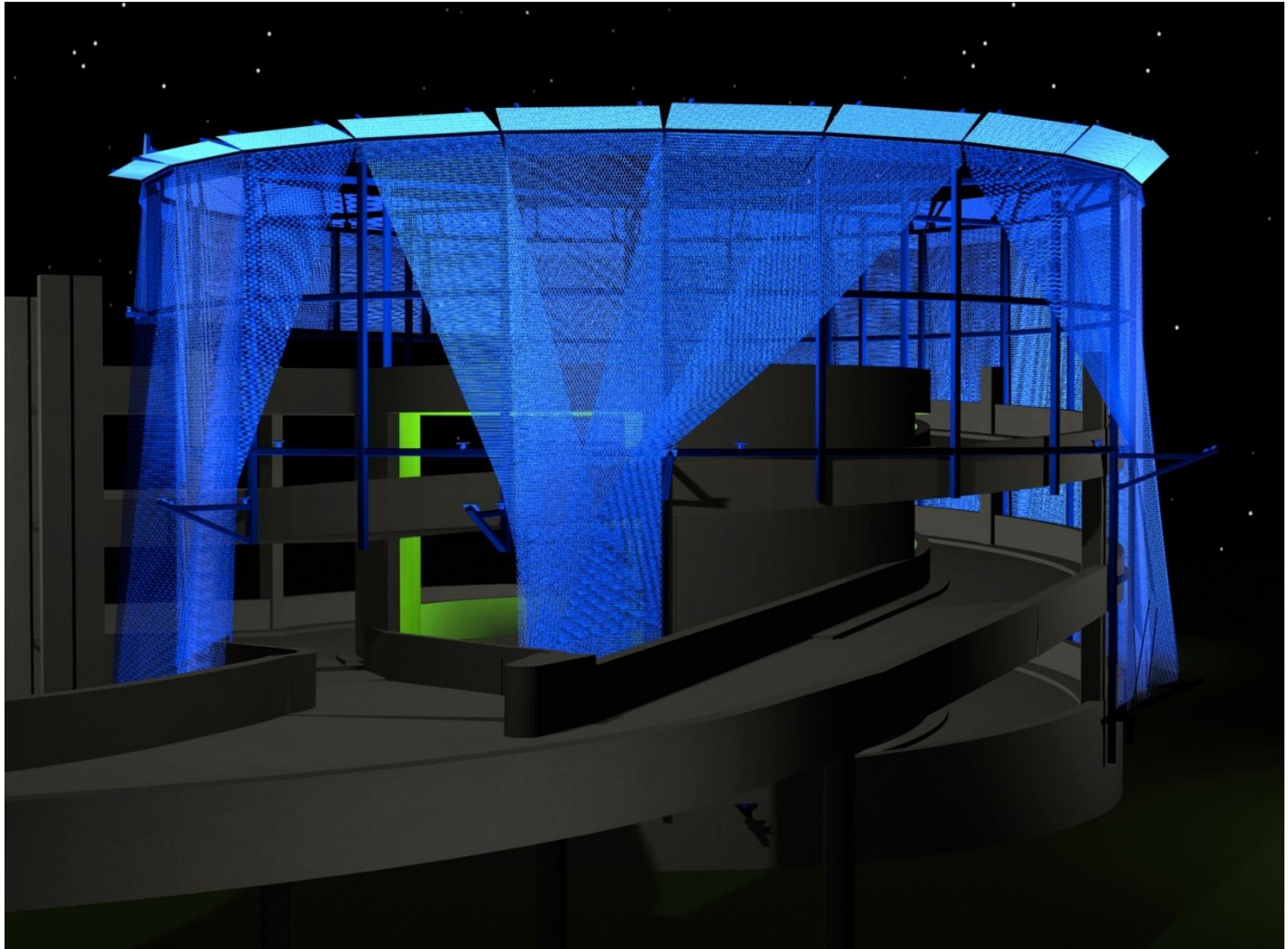

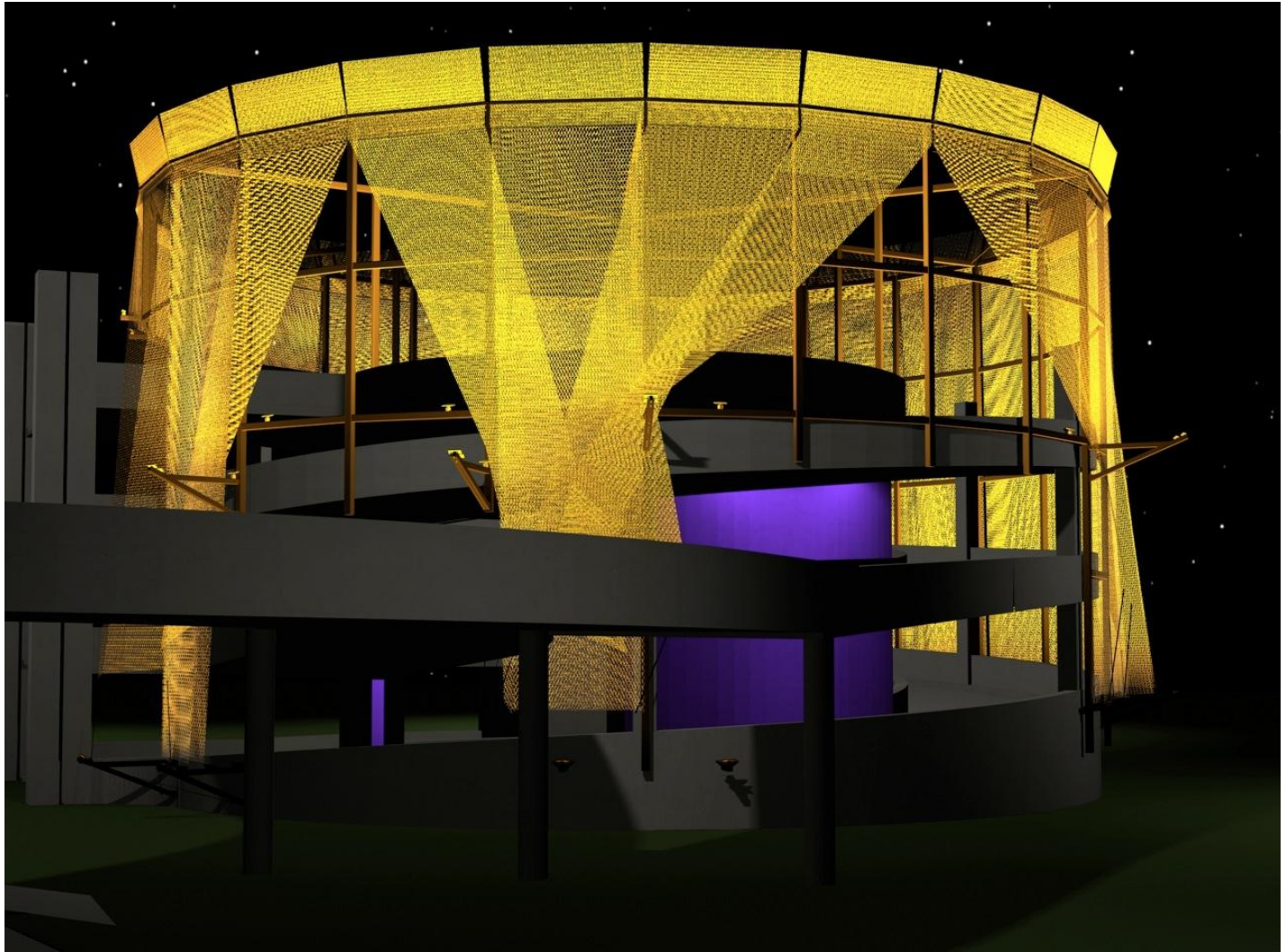



Spinning Our Wheels

Sea-Tac Airport Consolidated Rental Car Facility

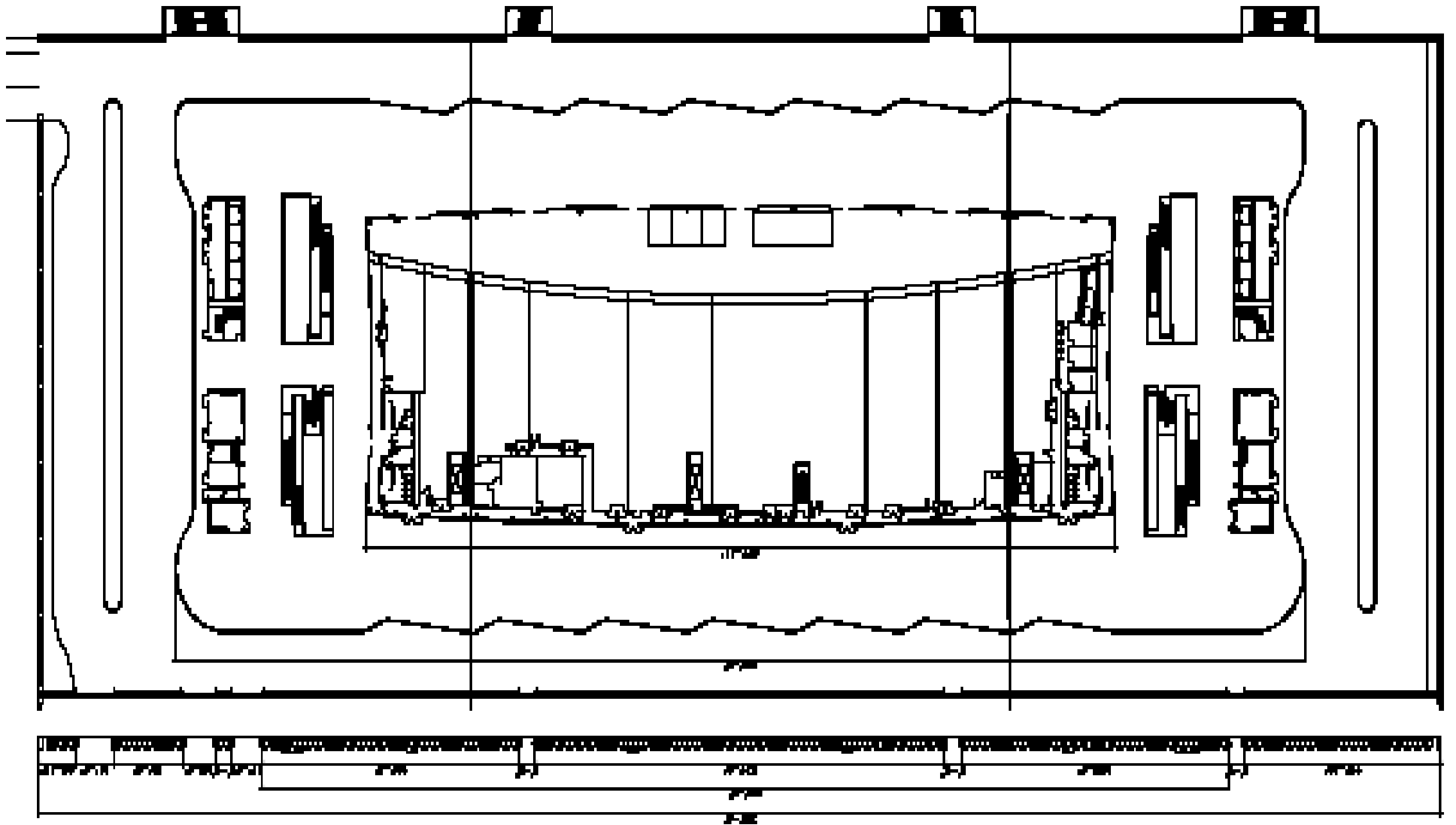

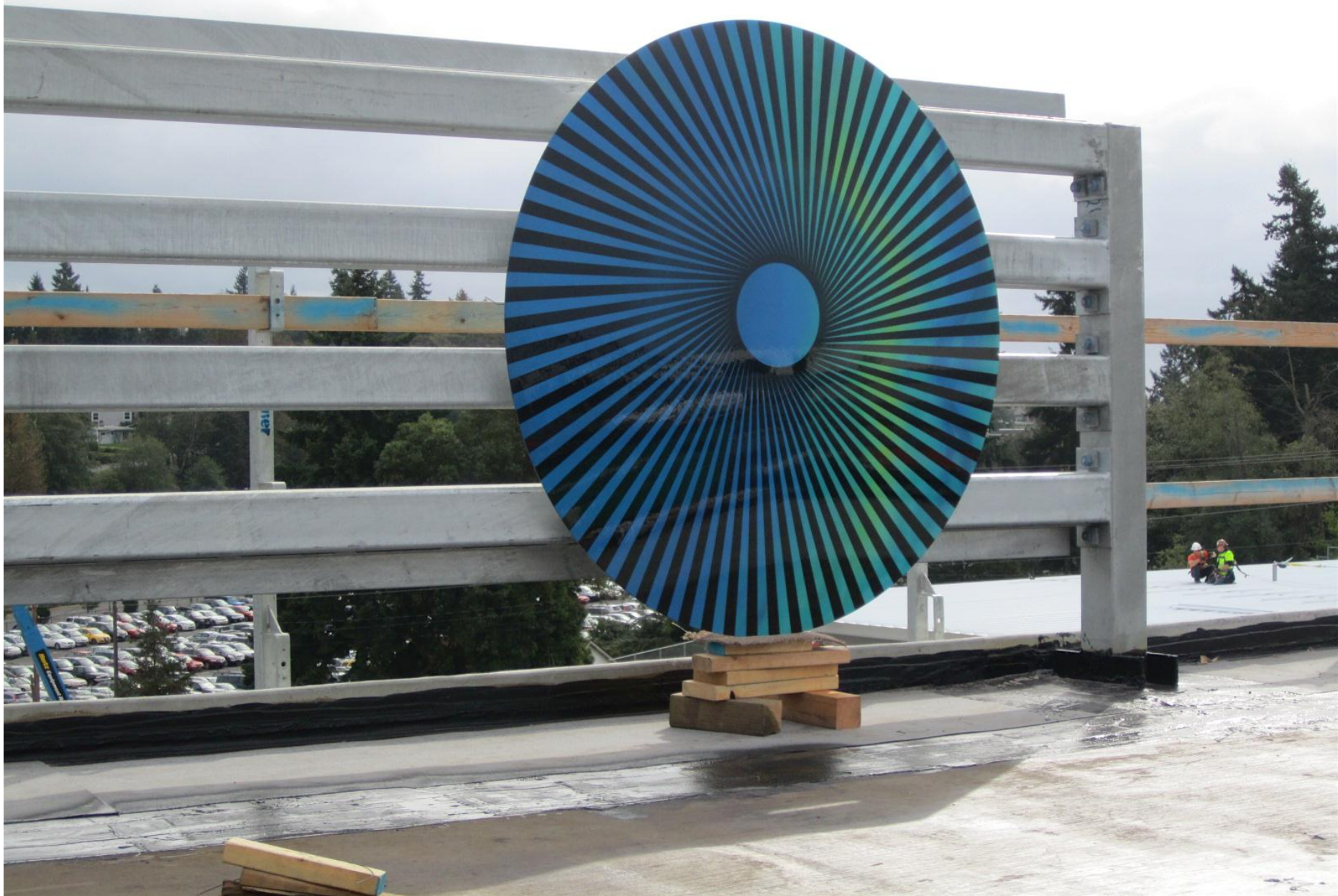

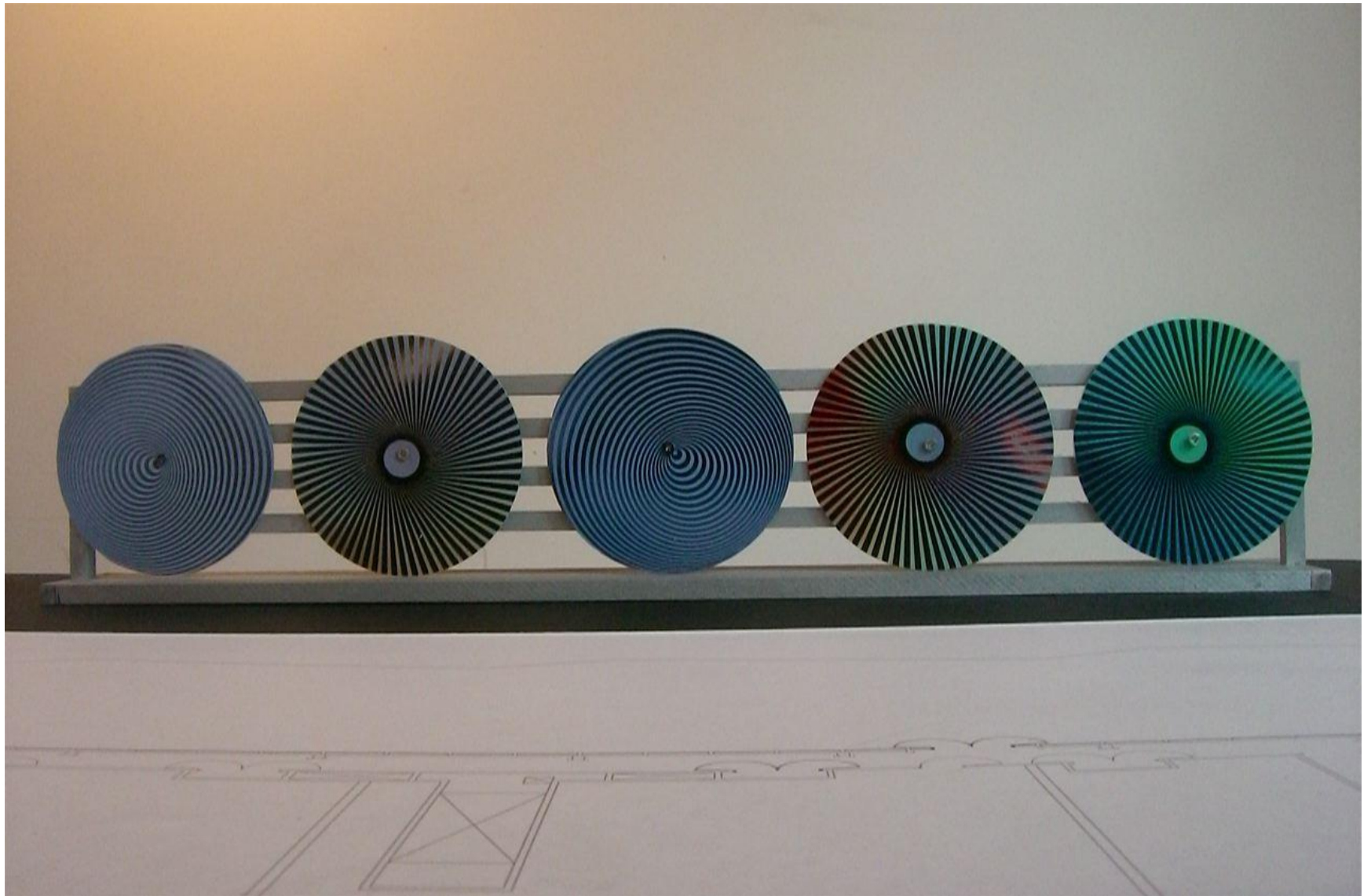

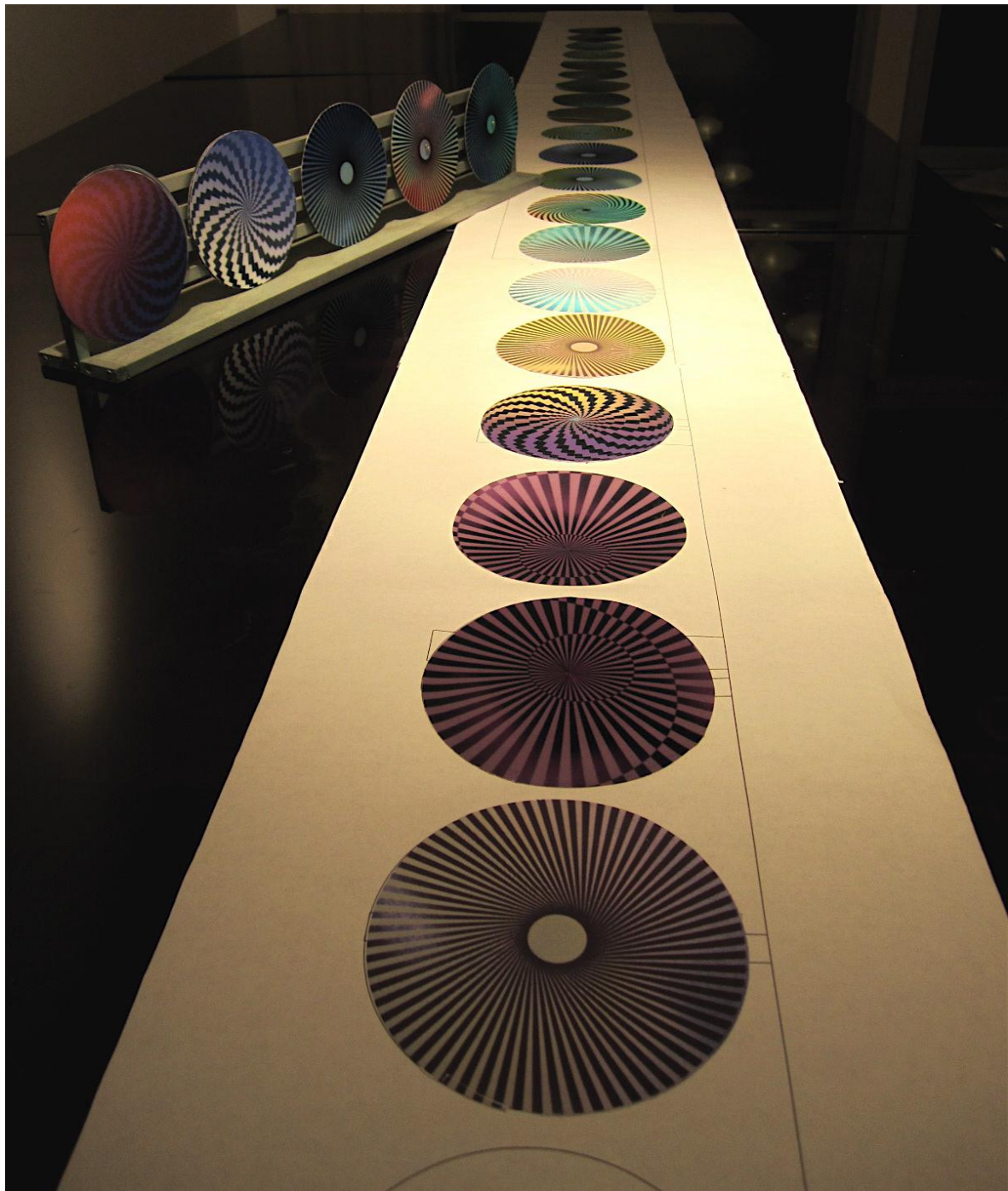







Art Pool

- Projects that qualify for art allocations are not good candidates for an art project themselves.
- The Art Program Policy and Guidelines provides for the collection of percent-for-art allocation monies from such projects in an Art Pool.
- An art project could be eligible for Art Pool funds if it would aid in one of the following elements:
 - mitigating impacts of construction
 - unifying treatments
 - aiding way-finding
 - providing a gateway or portal
 - providing a focal point
- **Remaining Balance in Art Pool** **\$1,351,797**





Male

Female



Skirt-
Raven
----->

Skirt-
Killer whale
<---

Bentwood Box
as bases for both

Octopus and salmon